



- MP Series
- LC Series
- SL Series
- KR Series



- RT Series
- RS Series
- BR Series
- RD Series
- AC & DC Motors



- Couplings
- Torque Limiters



- Linear Actuators
- Linear Screw Jacks
- Linear Slides



12910 Galveston Road
Webster (Houston), TX 77598
Tel: (281) 480-5711
Fax: (281) 480-8656

Visit our website at:
www.sipco-mls.com

DISTRIBUTED BY



KR Series





KR SERIES



SIPCO offers a complete product line of standard and precision components.

SIPCO has been satisfying customers since 1984. In that time, we have established a reputation for providing product services & Mechanical Linkage solutions to industries using motion control, power transmission, and hydraulic systems. Today, our products are in applications, including robotic, packaging, automotive, printing and material handling applications to name a few. Through this experience, we are continually evolving, offering new innovative solutions for high-tech applications. When you have one source, you only have to place one order to fill your Mechanical Linkage needs.

Bevel helical units type KR, manufactured under the most stringent quality specifications, are designed for dynamic and accurate applications where light weight and space effectiveness are a factor. Many options can be selected from the catalog as far as motor adapters and output shafts configurations that facilitate the installation on the driven equipment.

- Available in only one backlash option ($\phi = 8'$)
- Single reduction; ratios $i = 1, 2, 5$
- Radial ball bearings are of standard supply, while taper roller bearings can be optionally specified for particularly demanding loading conditions.
- Degree of protection IP65
- Max. noise level $L_p \leq \text{dB (A)} @ n_1 = 3000 \text{ min}^{-1}$
- Units are factory charged with synthetic lubricant suitable for operation at ambient temperatures in the range $0^\circ \dots 40^\circ\text{C}$. The lubricant quantity is affected by mounting position, which therefore will have to be specified at the time of ordering. In the absence of contamination lubricant does not require periodical changes.

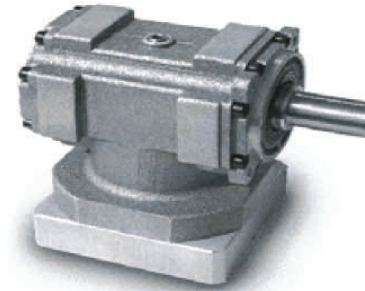

duty	KR 10	KR 20	KR 30	KR 40
S1	O/V	O/V	O/V	O/V
S5	G/V	G/V	G/V	G/V

Legend:

S1=continuous duty O=synthetic oil viscosity ISO VG 220 V=Viton® seals
 S5=intermittent duty G=NLGI grease consistency 00

